

# Linear guide rail

# LFS-12-2



## Features

- W 62 x H 31 mm
- 2 precision steel shafts Ø 12
- Anti-twist lock
- Aluminium shaft housing profile, naturally anodised
- High parallelism through patented shaft housing outline
- High guidance accuracy
- Securing from above or below using drilled holes Ø 6.5 in 100 mm raster on flat surface
- Lengths in 100 mm raster
- Max. length up to 2998 mm
- Special lengths to order
- Weight: approx. 3.3 kg/m

## Ordering key

**235 200 XXXX**

Length in mm  
 e.g. **0298** = Length 298  
**0998** = Length 998  
 Profile length = Length overall L -2 mm

## Aluminium slides

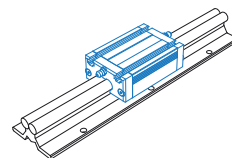

- With recirculating ball guide
- Clamping surface plane milled
- Adjustable for no play
- Option: stainless steel version

L 94 x W 62 x H 31.5 mm (WS 4/70)  
 (weight: approx. 0.33 kg)

Part no.: **223104 0070**  
 Stainless steel: **223104 1070**

L 124 x W 62 x H 31.5 mm (WS 4)  
 (weight: approx. 0.46 kg)

Part no.: **223104**  
 Stainless steel: **223104 1000**

## Load data

Shaft slides WS 4/70	
C <sub>0</sub>	3003 N
C	1873 N
F <sub>1</sub> static	2821 N
F <sub>1</sub> dynamic	1599 N
F <sub>2</sub> static	3303 N
F <sub>2</sub> dynamic	1873 N
M <sub>x</sub> static	29.8 Nm
M <sub>y</sub> static	105.3 Nm
M <sub>z</sub> static	123.3 Nm
M <sub>x</sub> dynamic	16.8 Nm
M <sub>y</sub> dynamic	59.7 Nm
M <sub>z</sub> dynamic	69.9 Nm

Shaft slides WS 4	
C <sub>0</sub>	4868 N
C	2426 N
F <sub>1</sub> static	4157 N
F <sub>1</sub> dynamic	2071 N
F <sub>2</sub> static	4868 N
F <sub>2</sub> dynamic	2426 N
M <sub>x</sub> static	43.9 Nm
M <sub>y</sub> static	155.2 Nm
M <sub>z</sub> static	181.7 Nm
M <sub>x</sub> dynamic	21.8 Nm
M <sub>y</sub> dynamic	77.3 Nm
M <sub>z</sub> dynamic	90.5 Nm

Trolley LW 3	
C <sub>0</sub>	2160 N
C	4000 N
F <sub>1</sub> static	4320 N
F <sub>1</sub> dynamic	3846 N
F <sub>2</sub> static	2160 N
F <sub>2</sub> dynamic	4000 N
M <sub>x</sub> static	109.5 Nm
M <sub>y</sub> static	194.4 Nm
M <sub>z</sub> static	97.2 Nm
M <sub>x</sub> dynamic	97.4 Nm
M <sub>y</sub> dynamic	173.0 Nm
M <sub>z</sub> dynamic	180.0 Nm

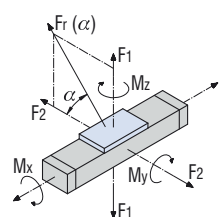

$$Fr(\alpha) = \frac{F_2}{\cos \alpha}$$

$$Fr(\alpha) = \frac{F_1}{\sin \alpha}$$

## Steel slide LS 1

- L 91 x W 60 x H 32 mm
- clamping surface ground
- weight: approx. 0.8 kg

Part no.: **223006**

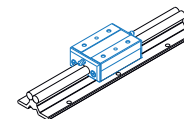

## Trolley LW 3

- L 125 x W 85 x H 7.7 mm
- Ground steel plate
- Weight: 0.93 kg

Part no.: **223008**

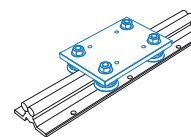

# Linear guide rail

# LFS-12-2

## Bending

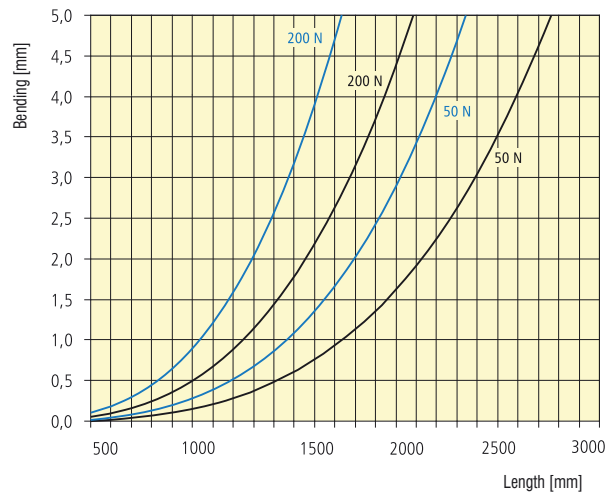
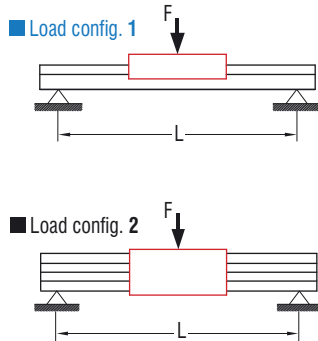

## Dimensioned drawings

LFS-12-2 with aluminium slides WS 4/70 or WS 4

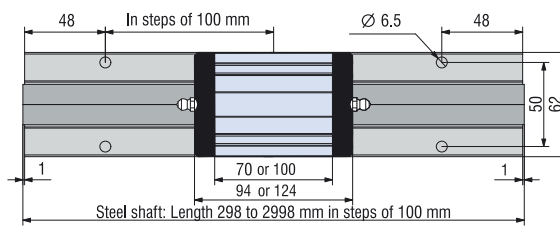
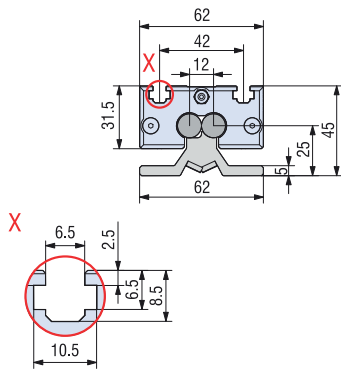

LFS-12-2 with trolley LW3

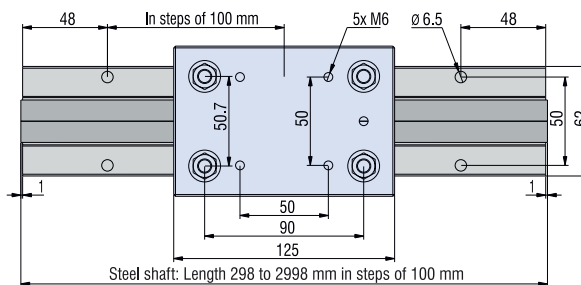
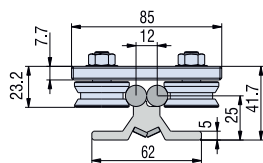

LFS-12-2 with steel slide LS 1

